

CURVE TABLE						
NO.	RADIUS	LEN.	DELTA	TAN.	CHD.BRG.	CHD.LEN.
C1	485.00	168.25	+ 19°52'35"	84.98	S 82°30'32" E	167.41
C2	297.50	109.66	+ 21°07'07"	55.46	S 14°18'14" W	109.04
C3	1243.73	432.11	+ 19°54'23"	218.26	S 34°48'59" W	429.94
C4	50.50	224.78	255°01'55"	65.77	N 7°42'52" W	80.11
C5	20.00	32.74	75°01'55"	19.19	N 82°17'08" E	30.45
C6	25.00	32.50	- 74°28'41"	19.00	N 82°28'10" W	30.26
C7	46.00	204.31	254°28'41"	60.52	N 7°31'50" E	73.24
C8	1198.73	371.48	- 17°45'20"	187.24	N 33°44'27" E	369.99
C9	252.50	88.83	- 20°09'21"	44.88	N 14°47'07" E	88.37
C10	490.00	14.67	- 1°42'53"	7.33	S 75°33'38" W	14.66
C11	25.00	22.11	- 50°40'08"	11.84	S 49°22'07" W	21.40
C12	46.00	225.87	281°20'15"	37.69	N 15°17'49" W	58.31
C13	25.00	22.11	- 50°40'08"	11.84	S 79°57'45" E	21.40
C14	530.00	19.00	+ 2°03'13"	9.50	N 75°43'47" E	18.99

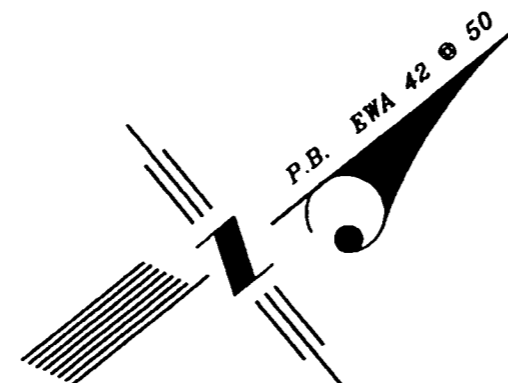

PLAT THREE  
VICTORIA'S GRANT  
PARCEL "A"  
P.B. EWA 42 @ 49

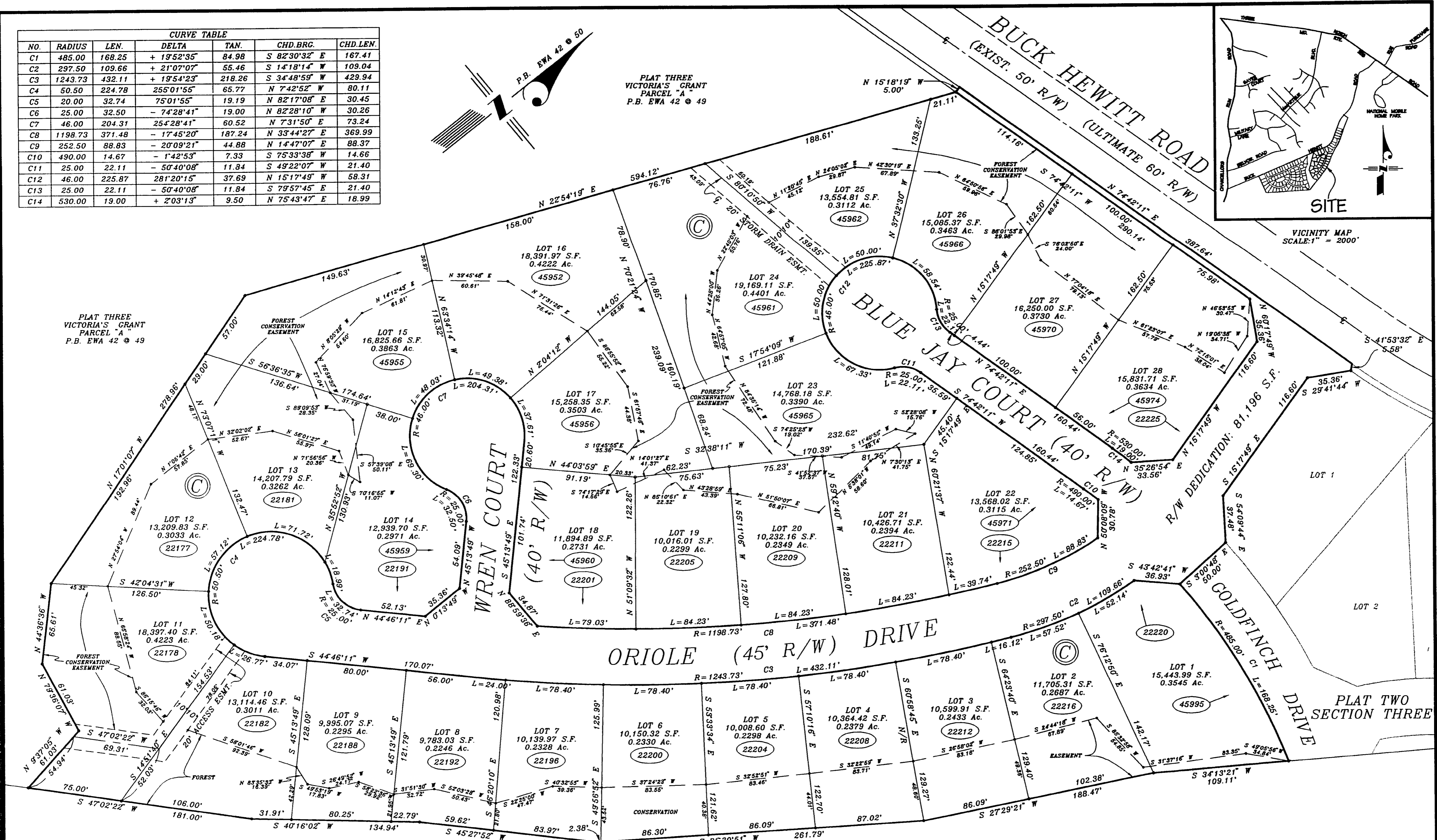
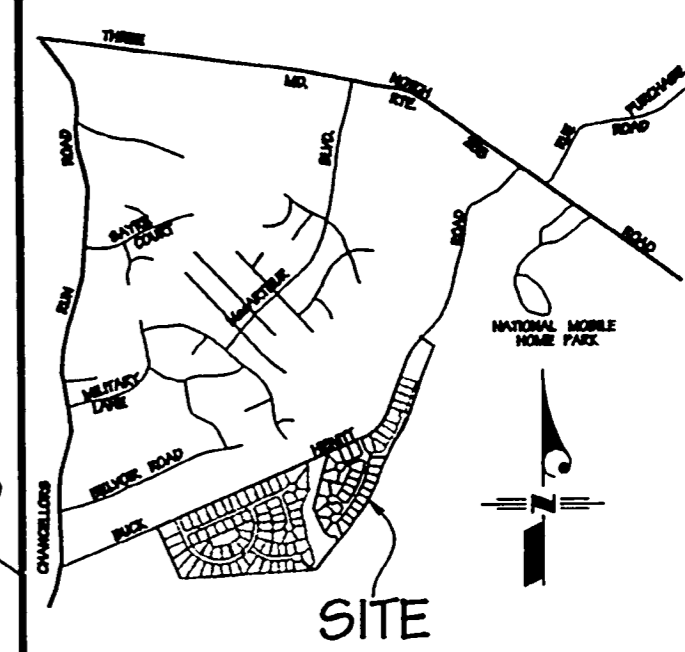

JOSEPH M. HEARD  
L. 141 @ F. 9

PLAT ONE - SECTION THREE  
LOTS 1 THRU 28 BLOCK C  
**VICTORIA'S GRANT 46 III**  
EIGHTH ELECTION DISTRICT  
ST. MARY'S COUNTY, MARYLAND  
MAY, 1998  
SCALE: 1" = 50'

OFFICE OF PLANNING & ZONING  
Date \_\_\_\_\_  
Director \_\_\_\_\_  
Chairman \_\_\_\_\_

ST. MARY'S COUNTY METROPOLITAN COMMISSION  
Director *J. W. [Signature]*  
9/16/98

DEPARTMENT OF ENVIRONMENTAL HEALTH  
Date *10/7/98*  
Health Officer *[Signature]*  
Director, Env. Hygiene \_\_\_\_\_  
Sanitarian \_\_\_\_\_

DEPARTMENT OF PUBLIC WORKS  
Date Approved *10-2-98*  
Approved Reference *CP-9799-002 PWA 7/20/98*  
*[Signature]*

Drawn By: MARTIN  
Checked By: BPR

**RDA**  
REAL ESTATE DEVELOPMENT TECHNOLOGY ASSOCIATES, INC.  
ENGINEERS LAND PLANNERS LAND SURVEYORS  
14603 MAIN STREET  
UPPER MARLBORO, MARYLAND 20772  
PHONE: (301) 627-3100

MSA SSU 1252 - 5007-2